

# MEETING THE CHALLENGE!

Office of Institutional Advancement | Fall 2010



ARKANSAS STATE  
UNIVERSITY

BEEBE  
TM

BEEBE | HEBER SPRINGS | SEARCY | LITTLE ROCK AIR FORCE BASE

## TRANSFORMING LIVES THROUGH QUALITY LEARNING EXPERIENCES!

INTEGRITY

DIVERSITY + GLOBAL AWARENESS

EXCELLENCE

ACCESS

STUDENT-CENTERED

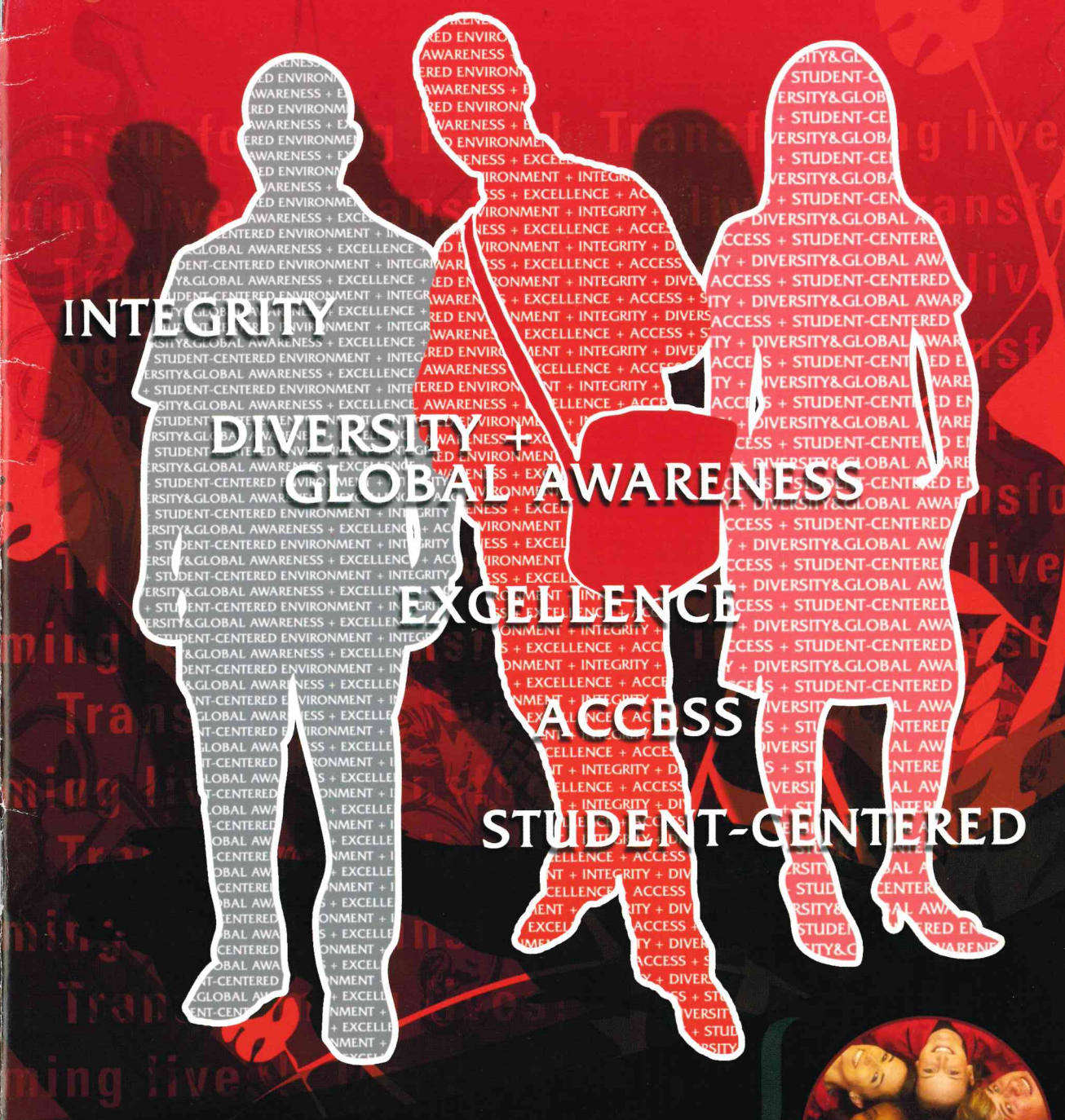

### OUR CORE VALUES (I.D.E.A.S.)

While strengthening our practice of being student-focused, we will guide our internal conduct as well as our relationships with those we serve by applying the values of **integrity**, **diversity**, **excellence**, **access**, and a **student-centered environment**.





## DR. EUGENE MCKAY ASU-BEEBE CHANCELLOR



If I remember correctly, last year was the first time in my 44 years at ASU-Beebe that we failed to give a cost-of-living raise to faculty. That was especially disappointing since ASU-Beebe faculty and staff salaries were already over \$5,000 below SREB (Southern Regional Educational Board) average. Yes, we do know that thousands of people have lost jobs, and we are thankful ASU-Beebe employees were not affected in this way, and we also recognize that Arkansas is doing better economically than most states—thanks to the Revenue Stabilization Act and Governor Beebe's leadership. However, it has been a tough year for most Arkansans, including college and university personnel.

Because state revenue has been down, most of us are in a holding pattern—trying to keep the ship afloat. **I always use the down times as planning times.** To some extent, the future will be what we make it, so we need a strategic plan to be prepared to move our university forward and to meet the needs of the people we serve.

Consequently, **we have spent a great deal of time this past year developing and implementing a new strategic plan.** First, we examined ourselves to be certain that we knew who we are and what we are striving to accomplish. We then established the following core values:

1. **Integrity:** We value integrity by having honesty and truthfulness in the consistency of our actions, methods, and principles.
2. **Diversity:** We value diversity and global awareness by assisting our students and employees to increase their exposure to and understanding of our diverse local, state, and global societies and their impact on cultural and economic well-being.
3. **Excellence:** We value continuous improvement and strive for excellence by accomplishing our tasks with distinction.
4. **Access:** We value access to educational opportunities by providing multiple locations and diverse programs and delivery methods.
5. **Student-Centered:** We value a student-centered culture by focusing on the needs, abilities, interests, and education of our students as our highest priority.

**Even in these tough times, we have made efforts to better serve our students as well as the businesses and industries of our state and region.** We believe Governor Beebe is absolutely correct that we cannot have economic development without quality education. Education has never been more important than in these tough times when Arkansas businesses and industries must compete in the global marketplace.

Economically, last year may have been a down year, but down is looking up. State revenue is looking better; 401k's are growing. The mountain top is in sight again, and we must be prepared to pursue our goals.

# DEBORAH GARRETT, Ed.D.

## ADVANCING HIGHER EDUCATION

1

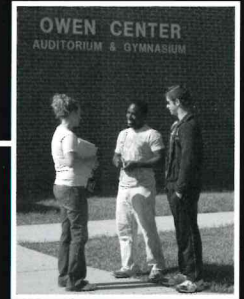

DR. DEBORAH GARRETT



**Dr. Deborah Garrett**, vice chancellor for student services at Arkansas State University-Beebe, has been elected as a member-at-large on the executive committee of the **Council for the Advancement of Standards in Higher Education (CAS)**.

The board members who serve as directors from 37 different higher education associations unanimously elected Dr. Garrett to this three-year term. In this role she will focus on CAS outreach including the use of CAS in professional practice.

CAS develops standards of practice and advances self-assessment of various higher education functions in their work toward college student learning and developmental outcomes.

Garrett has represented the National Council on Student Development of the American Association of Community College for nearly 10 years on the CAS Board of Directors. She is a strong advocate for the community college context and experience. She has participated actively on several CAS committees, including the Financial Advisory Board and most recently chaired the CAS revision of the Career Services standard. She has implemented a CAS self-assessment at ASU-Beebe.

Garrett has served as vice chancellor for student services at ASU-Beebe since 2008.

"MEETING THE CHALLENGE" is published annually by the Office of Institutional Advancement, Arkansas State University-Beebe, Palm and Iowa Streets, Beebe, Arkansas, 72012-1000. Bulk, non-profit postage paid at Little Rock, AR. This publication is distributed free-of-charge to ASU-Beebe alumni, supporters, and personnel. For additional copies, please contact 501-882-8855. Edited by Colbie Moody-Falwell. Layout and design by Jason A. Marzewski.



## DR. RUTH COUCH MR. BRANDON FULLER

2

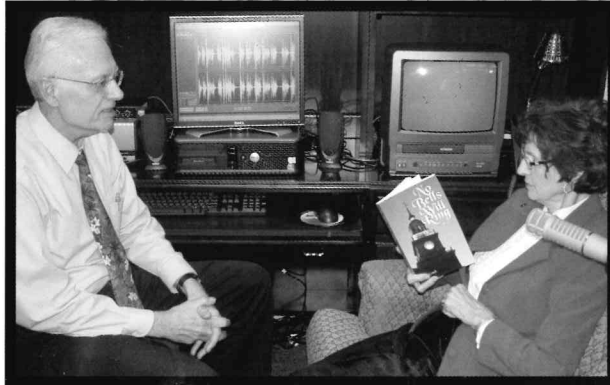

**Dr. Ruth Couch**, professor emeritus of Arkansas State University-Beebe, recorded her recently published book, **“No Bells Will Ring,”** for Arkansas Information Reading Services for the Blind (AIRS).

Couch, who is currently the Executive Director of the Beebe Chamber of Commerce, was approached by Charles Moore, assistant professor of mathematics at ASU-Beebe, about the possibility of reading her book for the Arkansas Services for the Blind.

Moore has read different publications for AIRS over the last year, including National Geographic and Oxford American. “I had worked as an announcer for a number of radio stations, and I still do occasional voice work for stations and narratives for special videos. I thought this would be a great way to volunteer my time,” Moore said. It occurred to him that the reading of a local author’s book for AIRS would be of special interest to listeners so he suggested to Couch that she read her book. “I was very excited when Dr. Couch agreed to read her book. Her characters really come to life through her voice,” stated Moore.

Moore set up the recording equipment every Thursday and Couch would record segments of her book. After several months of recording, Couch has finished recording her book. **A copy of Couch’s recording will soon be available to the public in the ASU-Beebe Abington Library.**

Couch’s book is set in a South Arkansas town in the 1960s. Her book illustrates the intergenerational conflict between a mother and her child and how the child helps the mother overcome grief and move on with her life. “People from different generations can misunderstand each other, even when they have the best intentions,” Couch said. “I hope that people can identify with that within their own families.”

**Brandon Fuller**, of Batesville, recent graduate and former ambassador, looks forward to the next step in his education.

Fuller began ASU-Beebe with the Incentive Scholarship which he turned into a full scholarship after the first semester by keeping a 3.25 grade point average. Fuller received numerous awards while at ASU-Beebe including the Division Award for Business and Agriculture and Ag Club Outstanding Freshman of the Year. He was also an ambassador in the Admissions Office and the vice president of the Ag Club. Fuller received one of the Citizenship Awards last spring which goes to two students with overall academic success and leadership qualities.

**“My experience at ASU-Beebe has been fantastic. You don’t just meet people here, you really get to know them,” Fuller said.**

Fuller is continuing his education by attending the ASU-Jonesboro Agricultural Business program on the ASU-Beebe campus.



# ARKANSAS STATE UNIVERSITY LITTLE ROCK AIR FORCE BASE

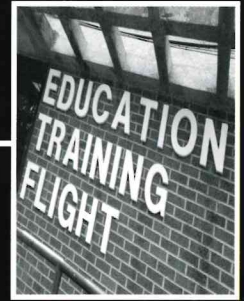

A S U - L R A F B

3

**Arkansas State University-Beebe was listed in the top 15 percent of colleges, universities, and trades schools doing the most to embrace America's veterans as students in the "2010 Guide to Military Friendly Schools."**

The Serviceman's Readjustment Act in 1994, also known as The GI Bill, opened the opportunity of education to millions of veterans returning from World War II. This opportunity continues for today's veterans.

A research team surveyed more than 7,000 schools judging each in four categories: 45 percent for certifications, programs and policies, which measures a school's non-financial efforts to recruit and retain military and veteran students; 35 percent for financial commitment to recruiting and retaining military and veteran students; 15 percent for a school's results, or success, in recruiting military and veteran students and 5 percent allocated to other categories, including a school's academic accreditations.

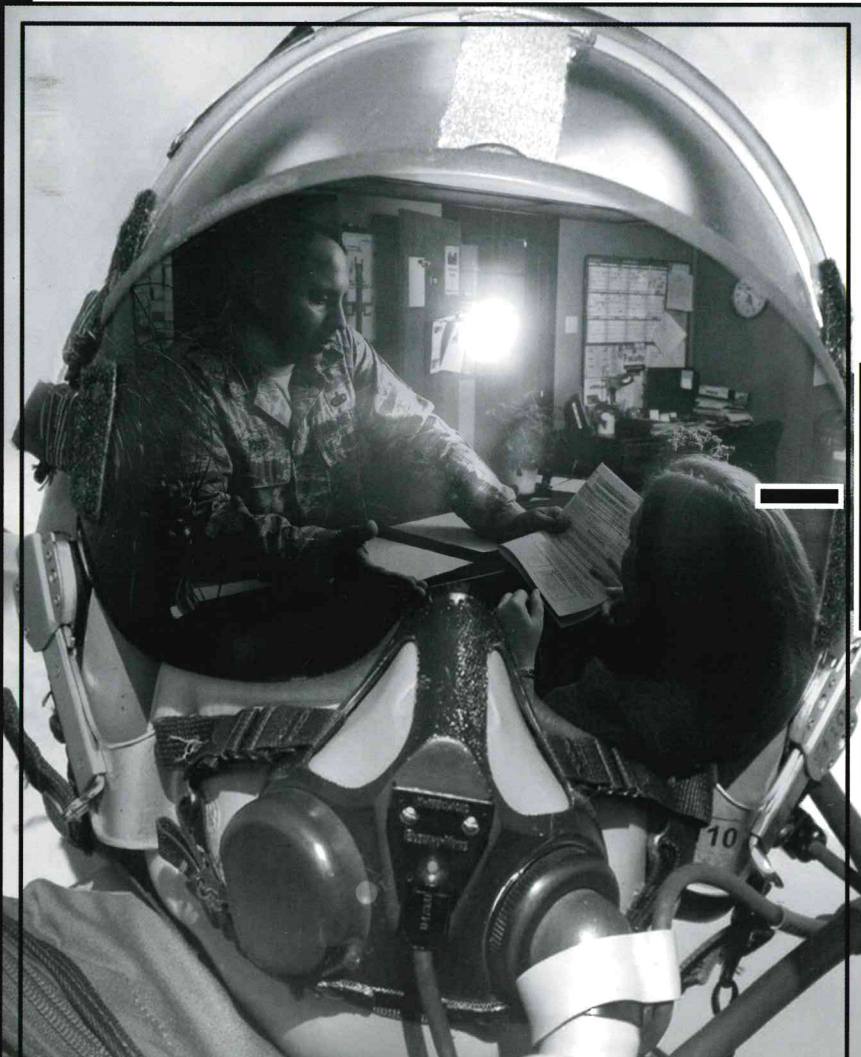



*Julie Baldrige*

**Julie Baldrige, director of public affairs and legislative relations for the Arkansas Scholarship Lottery**, spoke to the ASU-Beebe Development Council on July 8, 2010, about the **Arkansas Scholarship Lottery**.

The Arkansas Lottery started in September 2009 and the first scholarships were given this fall.



*Mark Raines*

ASU-Beebe would like to announce **Mark Raines**, director of communications for **Chesapeake Energy in Arkansas**, as a member of the **ASU-Beebe Development Council**. Raines joined Chesapeake in July 2005 following a 20-year career in local media.

His responsibilities include promoting Chesapeake and its mission.

From 1999-2005, Raines served as Director of News for KTHV, Channel 11 in Little Rock.

Raines is married and lives in Cabot with his wife and son. He is a graduate of Jacksonville High School and the University of Arkansas.



# ASU-SEARCY TRAINING THE WORKFORCE

5

**Arkansas State University-Searcy**, a technical campus of ASU-Beebe, began as Foothills Vocational Technical School in 1965. High-quality technical courses continue to be offered today.

**Our objective is to help students achieve the necessary job skills for the workforce in one year.** To achieve this goal, we have designed most of our programs to last one academic year.

Technical certificates and/or certificates of proficiency can currently be obtained in 14 courses: air conditioning, auto body repair, automotive technology, certified nursing assistant, computerized machining, diesel technology, emt/paramedics, health information, business, petroleum technology, pharmacy technician, practical nursing, and welding technology.

We offer specific or customized workforce training for our service area through our economic development department. When work started on the Fayetteville Shale, we met with the oil and gas companies about the opportunity to help train the workforce.

**We have currently trained 343 people to work in the oil and gas industry and have become the national training center for Nomac Drilling, a Chesapeake Energy subsidiary.**

Many high school students in this area have the opportunity to attend classes for credit through our regional career center. The regional career center offers classes at ASU-Beebe, ASU-Searcy, ASU-Heber Springs, Bald Knob Public School and Lonoke Public School. Over 1000 college credit hours were awarded last year to high school students. These opportunities allow students to finish certain programs early and then enter the workforce quicker than a traditional student.





## MR. GARTH MARTIN ALUMNI OF THE YEAR!

6

**Garth Martin has seen many changes at ASU-Beebe and has been a supporter through them all.** Garth actually lived on the ASU-Beebe campus while attending Beebe High School then transferred to ASU-Beebe to play basketball.

Garth became one of the “Minuteman” coached by Bro Erwin. “He was a great coach and taught me a lot about basketball,” said Martin. **“ASU-Beebe has really grown since I was a student. I had great teachers and they helped me succeed.”** Garth finished first in his class and transferred to Hendrix to play basketball and football and run track.

After working in insurance for 50 years, Garth retired but has not slowed down. He volunteers at the Clinton Library and Heifer International and is a member of the Pulaski County Democrat Committee. He and his wife, Joann, were Arkansas Travelers for former President Clinton, went to both inaugurals and volunteered for two weeks at the White House. Garth is also very involved in his church and has been on at least four mission trips to Russia. When he is not volunteering, Martin also works part-time. He jokes that he is busier now than before he retired.

Garth and Joann have been married fifty-eight years and have three sons and eight grandchildren.

Garth has been a member of the ASU-Beebe Development Council since its inception in 1996. **He will be honored at the Arkansas Association of Two-Year Colleges Conference this October as the ASU-Beebe Alumni of the Year.**

**“I am honored and have enjoyed serving on the ASU-Beebe Development Council. The progress that it has seen in the last several years is amazing. I hope that I have been a benefit to the council and its members,”** Garth said.

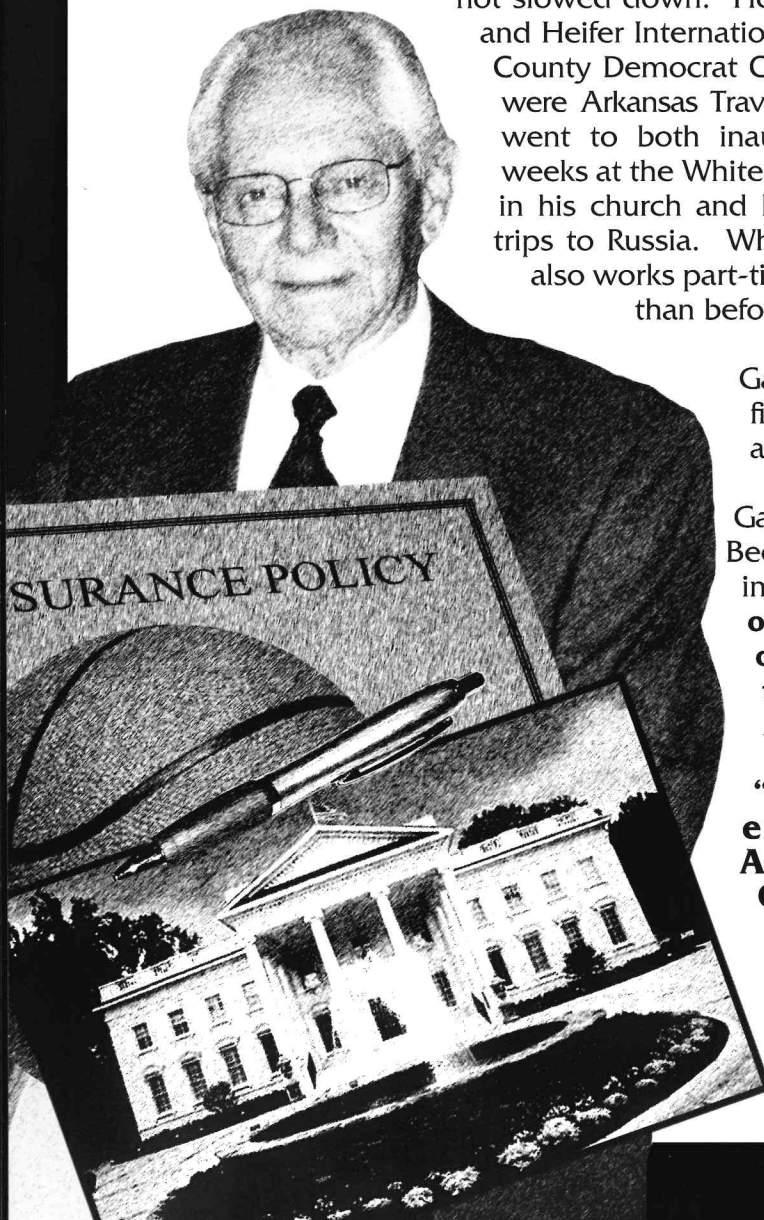



## MR. JEREMY GILLAM ASU-BEEBE DEVELOPMENT COUNCIL



JEREMY GILLAM

7

**Jeremy Gillam was named to the United States Department of Agriculture's Fruit and Vegetable Advisory Committee this year.** Gillam will serve a two-year term on the committee.

Gillam is a specialty crop producer and co-owner of Gillam Farms in Judsonia, Ark. Gillam Farms is a family owned operation consisting of over 500 acres of fruits and vegetables. Their main crops consist of blackberries and blueberries but they also grow a wide variety of other food such as: asparagus, gourds, grapes, muscadines, okra, purple hull peas, and squash.

Members of the committee represent fresh fruit and

vegetable growers/shippers, fresh fruit and vegetable wholesalers, retailers, industry trade associations, importers, fruit and vegetable processors, food service suppliers, fresh-cut processors, brokers, and state departments of agriculture.

The majority of farm revenues for the United States come from fruit and vegetables. **"I am extremely honored and excited to be able to represent Arkansas and our region on this committee,"** Gillam said. "The ability to affect national policy in an immediate way is very important."

Gillam has also served as the Chairman of the Arkansas Farm Bureau Horticulture Committee.

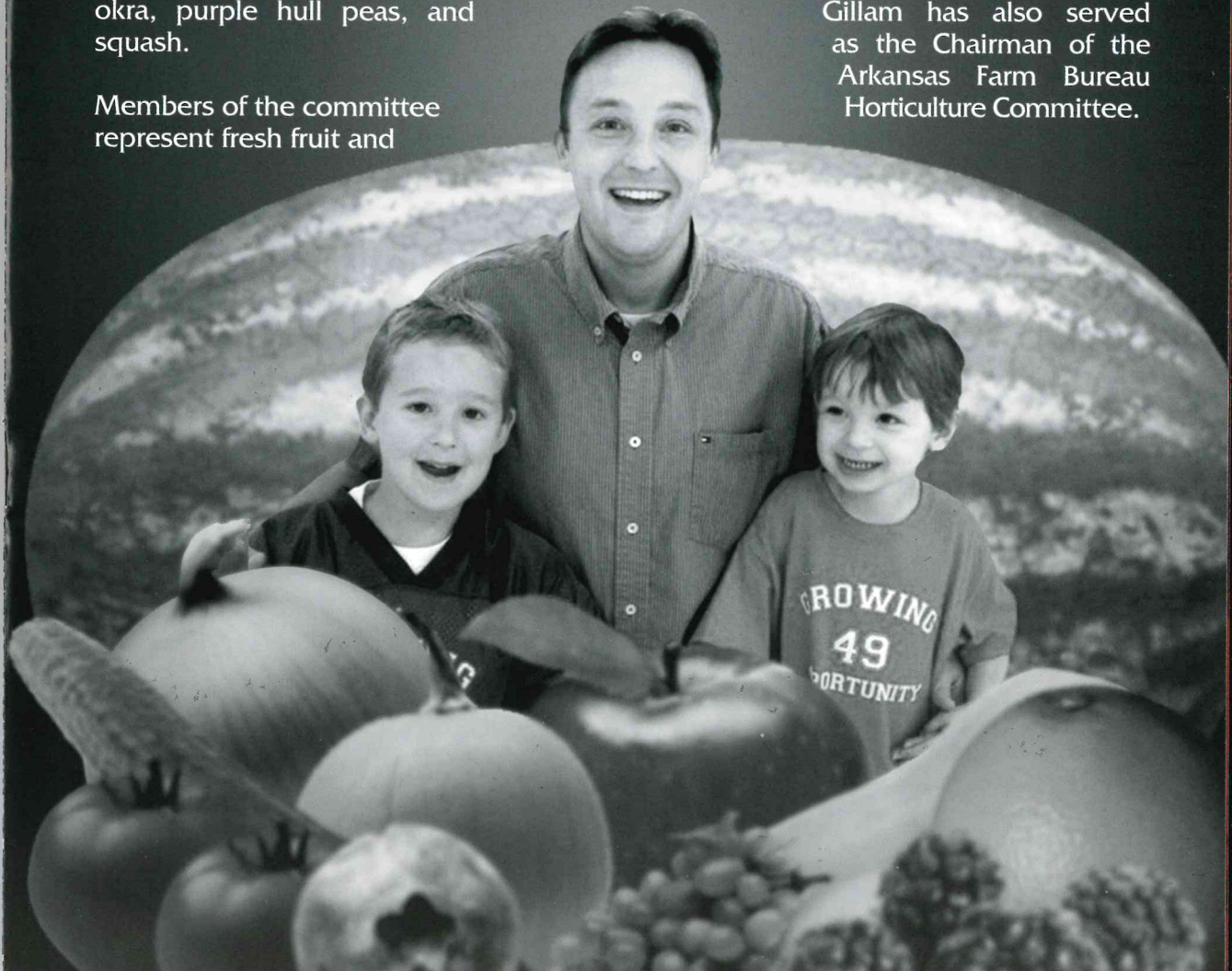



# ARKANSAS STATE UNIVERSITY BEEBE CAMPUS

8



**Arkansas State University-Beebe broke ground in April on two new residence halls** which will allow just over 100 additional students to live on campus.

The residence halls will be **two 28,610 square foot buildings** that will contain a combination of single and double suites to house a total of 248 students. Each floor will have study halls and each building will have a computer lab and a game room and lounging area. **All rooms will be Internet equipped.**

After a survey revealed that the students wanted to live closer to the Student Center, the new residence halls are being built just 50 yards to the east of the Student Center.

The residence halls construction occupied 200 existing parking spots. A new parking lot on the west side of the Student Center was completed by Fall 2010 to replace the lost parking.

The architect for the residence halls is **Brackett Krennerich of Jonesboro** and the contractor is **Dayco Construction, Inc. of Damascus**. Construction is scheduled to be completed for students to move in by Fall 2011.



# NEW RESIDENCE HALLS! (LIKE A GIANT LEGO SET!)

9

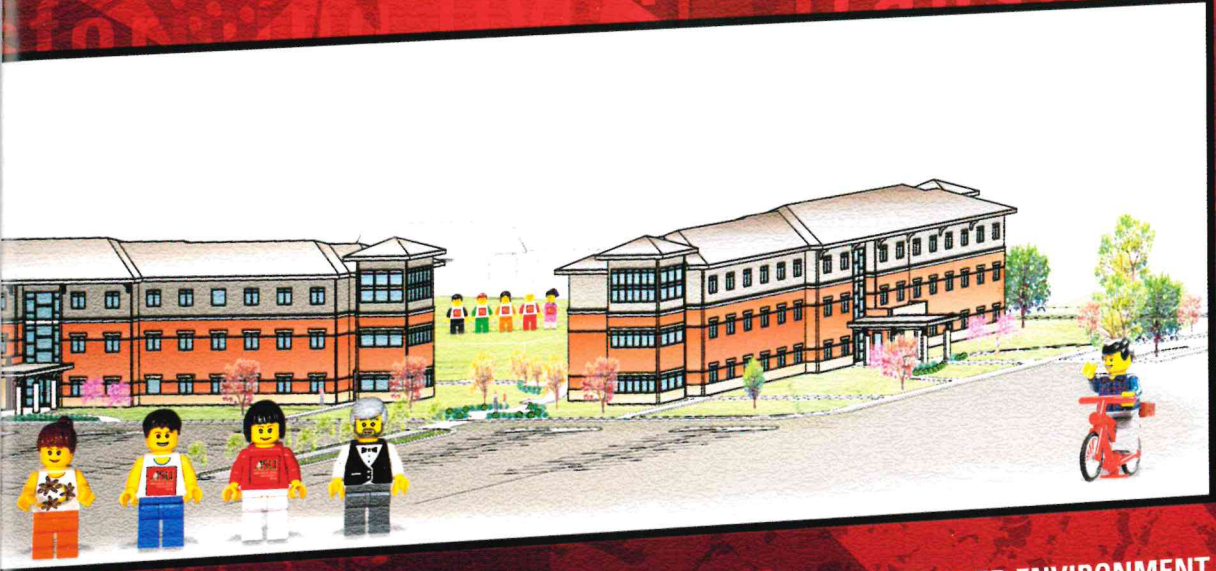

RSITY & GLOBAL AWARENESS, EXCELLENCE, ACCESS, + STUDENT CENTERED ENVIRONMENT





## ASU-HEBER SPRINGS SERVING WITH DISTINCTION

10



For 32 years the **Arkansas Community Service Awards** have recognized individuals and businesses for their dedication and commitment in supporting volunteerism throughout Arkansas. **Carol Ann Johnson, development officer/grants writer, was a September 2009 Community Service Award finalist.**

Johnson credits her farm roots in Cleburne County with fostering her desire to serve and educate others in her two home communities.

Among her many accomplishments, Carol was Mrs. Arkansas International 2008, a Business and Professional Women's State and National Young Careerist, and is President-elect of the Heber Springs Area Chamber of Commerce, a very busy career woman, community servant, and mom.

The awards are sponsored by the Department of Human Services-Division of Volunteerism (DOV), KARK Channel 4, The Governor's Office, and Duncan Law Firm.

**Sugarloaf Heritage Day was hosted on Saturday, May 18th, at the ASU-Heber Springs campus by the Sugarloaf Heritage Council.** This

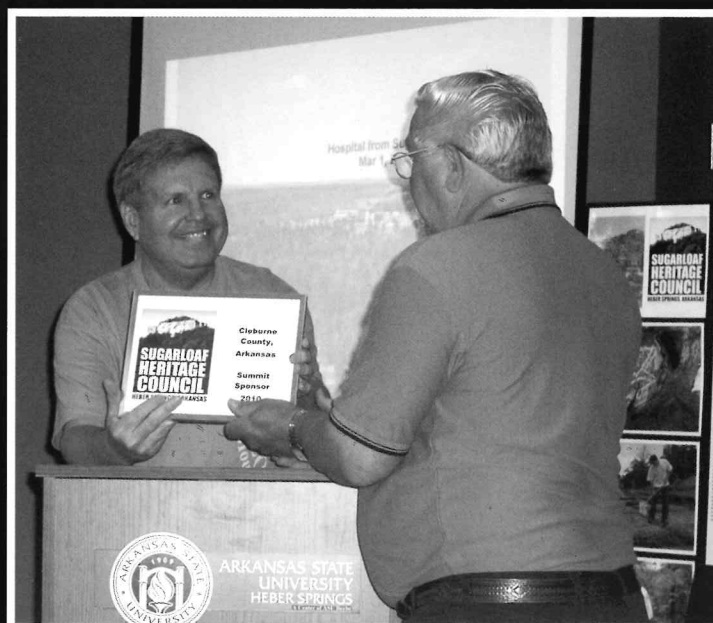

citizen led organization supports the growth of the campus but also works to promote the heritage of the land where the campus is located. They are currently conducting a membership drive and working to raise funds to preserve the trail going to the top of Sugarloaf Mountain, a historical landmark in the county.

**Seen in photo is Immediate Past President, Mark Johnson, presenting a volunteerism and membership award to Cleburne County Judge, Claude Dill.**

# AROUND ASU-BEEBE HIGHLIGHTS + ACCOMPLISHMENTS



**John Wooten** (right), president of Centennial Bank in Beebe donated \$10,000 to fund the ASU-Beebe Concert Lecture Series.



**Melinda Mayo** (right) from KATV Channel 7 came to ASU-Beebe during the "Spirit of Arkansas Road Trip."



**Brandon Fuller**, of Batesville, and **Karly Carter**, of McRae, received the **ASU-Beebe Citizenship Award**.



Graduates of the Leading Employees toward Advancement and Development (**LEAD**) Program at ASU-Beebe.



**Students at Beebe Elementary School** heard Jason Marzewski read his book, "Toad Meets His Forever-Friend."



Arkansas State University held its **board meeting** at ASU-Heber Springs on March 5, 2010.



ASU-Searcy held its second annual **Summer Technical College**. High school students took occupational technology courses.



U.S. Congressman **Vic Snyder** spoke at the graduation ceremony on April 30, 2010.



# INSTITUTIONAL ADVANCEMENT

### Have you seen us lately?

If not, you should see us now! We are growing and we know you will be proud. Every few years I make a plea for Arkansas State University-Beebe friends and family to come visit our main campus and all the campuses in the ASU-Beebe system. This year, I can add **Little Rock Air Force Base** to the mix. If you have passed the LRAFB entrance on Highway 67/167 you have probably noticed the new Education Center which will house all educational offerings. This will now allow civilian students to take classes without needing a base pass. Completion should be later this year. Please plan to visit this much needed and wonderful new education center.

The Beebe campus is in the process of adding **residential halls** for those students that wish to live on campus. The halls will rival any in the state and are waiting for a kind supporter of the university to pay for the naming rights of the buildings. **The Walter England Center** has been renovated with state-of-the-art classrooms and a beautiful art gallery for displaying student and community art exhibits. Please be on the watch for a grand re-opening later this year. If you haven't visited the **ASU-Searcy** campus in the last few years then please drop in for a tour. There are several new buildings on campus and the gas rig training is worth the observation.

Finally, **ASU-Heber Springs**, situated on Sugarloaf Mountain, is arguably the most beautiful campus in the ASU system and in the State of Arkansas. If you have not seen the campus since it opened, it is definitely worth the trip.

**ASU-Beebe has come a long way** from the few buildings that it occupied in the 40's and 50's. We may be getting larger but we still understand the importance of saying thanks to each member of our family. Once again, thank you for all of the support that you give to our university.

*-Keith Pinchback*

## 2011 ANNUAL FUND

Office of Institutional Advancement | ASU-Beebe | P.O. Box 1000 | Beebe, AR 72012-1000 | 501-882-8855 | [www.asub.edu](http://www.asub.edu)

BEEBE | HEBER SPRINGS | SEARCY | LITTLE ROCK AIR FORCE BASE



**I/We wish to make a gift to:**  
 Chancellor's Cabinet (\$5,000)  
 Chancellor's Circle (\$500)  
 Diamond Club (\$250)  
 Anniversary Club (\$100)  
 Friends of the University (\$35)  
 Other Amount

**GIFT INFORMATION:**  
 Enclosed is my gift of \$\_\_\_\_\_ or my pledge of \$\_\_\_\_\_ payable to the Arkansas State University - Beebe Annual Fund.  
 Please charge my credit card: Visa \_\_\_ MC \_\_\_ Discover \_\_\_ AE \_\_\_  
 Account #: \_\_\_\_\_ Expiration Date: \_\_\_\_ / \_\_\_\_

Donor(s) Name(s): \_\_\_\_\_ SSN# or Tax ID: \_\_\_\_\_  
 Address: \_\_\_\_\_ City: \_\_\_\_\_ State: \_\_\_\_\_ Zip: \_\_\_\_\_  
 Telephone Number: ( \_\_\_\_\_ )- \_\_\_\_\_ - \_\_\_\_\_ E-Mail: \_\_\_\_\_

- YOUR PLEDGE SUPPORTS:**
- Outstanding Alumni & Students
  - Student Awards
  - Community & Student Activities
  - Alumni Special Events
  - Faculty Awards
  - ASU-Beebe Promotion

# ASU-BEEBE ANNUAL FUND

13



ASU-BEEBE ANNUAL FUND

**We are honored to recognize these alumni, faculty, staff and friends who have made an investment in Arkansas State University-Beebe.**

## **LIFETIME MEMBERS**

### **50,000 AND ABOVE**

Wilma Beard  
Chesapeake Operating, Inc.  
Centennial Bank  
Ruth Couch  
Cathy Eoff  
First Arkansas Bank and Trust (HS)  
John Deere Foundation  
Dennis & Eva Gillam  
Nomac Drilling Corporation  
Brenda Shurley  
Scott Stevens-Pizza Pro  
The Garlinghouse Foundation (HS)  
Kenneth Turner - Russellville Family Clinic  
Union & Strong Drilling, Inc.

### **40,000 - 49,999**

First Arkansas Bank & Trust  
Taylor Gregory - Stuttgart Regional Medical Center

### **30,000 - 39,000**

James D. Devine  
First Electric Cooperative Corporation (HS)  
Marvin Jones  
Richard & Thelma Powell

### **20,000 - 29,999**

Entergy Searcy (HS)  
First Security Bank of Heber Springs (HS)  
Heber Springs Rotary Club (HS)  
Letain DeVore  
First Baptist Church of Beebe  
First Security Bank  
Donald W. Reynolds Foundation  
E. G. & Kay Van Train (HS)  
White River Medical Center

### **10,000 - 19,999**

E. H. "Doc" & Ruth Abington  
Eddie & Reita Adams  
Baldor Electric Company  
Mickey Barnett (HS)  
Brinkley Family Foundation (HS)  
Centerpoint Energy (HS)  
Howard & Alyce Chapin (HS)  
Sandra Cherry (HS)  
Jack & Olivia Dowell (HS)  
Walter & Louise England  
Entergy - Searcy  
Millard-Henry Clinic of Russellville-MLT/GIK  
Ed & Nelda Kennedy Family (HS)  
Annieta Mann  
David & June Marshall (HS)  
Garth & Joanne Martin  
Farris & Wanda McCoy Family (HS)  
Eugene & Judy McKay

Missouri Higher Education  
Loan Authority (MOHELA)  
Ben & Mary Anne Pickard  
Quality Rock (HS)  
Regions Bank  
Stephens Incorporated  
Wal-Mart of Searcy  
Nickie Whittaker

## **CHANCELLOR'S CABINET**

Arkansas Veterinary Medical Association  
John & Robin Hayes  
Marchia Sims

## **CHANCELLOR'S CIRCLE**

Pat Alexander (HS)  
Arkansas Crop Protection Association (HS)  
Carol Barnett (HS)  
Don Barnett (HS)  
James C. & Patricia Barnett (HS)  
James & Sandra Barnett (HS)  
Blanford Laboratory  
Jerry & Suzanne Carlisle  
Kathleen Chatman  
Charles & Jennie Cole  
Defiance Metal Products of Arkansas, Inc. (HS)  
Claude & Virginia Dill (HS)  
Cathy Eoff (HS)  
Barry & Linda Farris  
Deborah Garrett  
Mike Gibson  
Joe Hastings  
Lee Hayes  
Heber Springs State Bank (HS)  
Richard Herget, Jr. (HS)  
James & Karen Jackson (HS)  
Eric & Carol Johnson (HS)  
Ted & Sharon Kalthoff  
Guy & Charlotte Lacy (HS)  
Peggy Logan (HS)  
Rebecca Lynn (HS)  
Eugene & Judy McKay (HS)  
Richard & Margaret Moose (HS)  
Bernard Nichols  
Keith & Alana Pinchback  
Kenneth & Sandra Prater  
Remington Arms  
Marie Rundio (HS)  
Ness & Carolyn Sechrest (HS)  
Simmons First Bank  
Marjorie Spence (HS)  
David & Tonia Spradlin  
Aaron & Flora Stark (HS)  
Jerry Stark (HS)  
Merrellyn Stark (HS)  
Ricardo & Claudine Steffens (HS)  
Linda Storm (HS)  
Strother-Wilbourn Land Title Co.

Dianne Tiner (HS)

## **DIAMOND CLUB**

Tom & Marc Anderson  
BP America Products Co.  
James Barnett (HS)  
Mary Alice Comstock (HS)  
Frank & Hazel Dickey  
Doyle & Rose Mary Jackson  
Mark & Kathleen Johnson (HS)  
Keith & Sherry McClanahan  
Red River Boating LLC (HS)  
Service Group (HS)  
Tigg Corporation (HS)  
Vera Tolson

## **ANNIVERSARY CLUB**

Sharon Been  
Marion Berry (HS)  
Chris & Meleah Boyett (HS)  
Camp Bear Track Management Company, Inc. (HS)  
David & Rhonda Durham  
Charlie & Rosemary Frame  
C. J. & Janinne Giroir, Jr. (HS)  
Candace Gross  
John & Elizabeth Hoyt (HS)  
Michael & Linda Jeffrey  
R & D & S LLC (HS)  
Nicholas & Susan Lynch (HS)  
David McAfee (HS)  
Charles & Pat McClain  
Dale & Edith Miller (HS)  
Robins Miller  
Marty Moss (HS)  
J. L. & Jody Mullens (HS)  
Ronald Russ  
Charles Snelson  
Robert & Connie Thomas (HS)  
Jerry & Debbie Thompson  
Linda Titus (HS)  
Angie & Steve Totty  
Joseph Tournear (HS)  
Walter-McNair Appraisal Service (HS)  
Alvin & Cindy Wheeler  
White River Rural Health Center, Inc (HS)  
Workamper News, Inc. (HS)  
Rick & Rebecca Wolf

## **FRIENDS OF THE UNIVERSITY**

Cheryl Cherry  
Eva Graves  
Robert & Zettie Holland  
Keith & Kathy Williams

(HS) Refers to the ASU-Heber Springs Campus

ASU-Beebe's Office of Institutional Advancement offers several annual gift categories to fit every level of giving: **Lifetime Members** (cumulative gift of \$10,000 or more); **Chancellor's Cabinet** (\$5,999 - \$9,999); **Chancellor's Circle** (\$500 - \$4,999); **Diamond Club** (\$250 - \$449); **Anniversary Club** (\$100 - \$249); **Friends of the University** (\$35 or couple \$50 - \$99).

**Information on the ASU-Beebe Gift Clubs may be obtained by contacting Keith Pinchback, Office of Institutional Advancement, P.O. Box 1000, Beebe, AR 72012, or calling 501-882-8855.**

We have made every effort to ensure that this list is correct. If you find that we have omissions or errors, please let us know.



## CONGRATULATING OUR RETIREES PLEASE VISIT US SOON!

14



**Arkansas State University-Beebe honored its recent retirees at a reception. The following staff and faculty were honored:**

**Linda Allee**, assistant professor of math, retired with 26 years of service; **Anita Baker**, institutional printer, retired with 31 years; **LaVerne Drennan**, bookstore cashier, retired with 17 years of service; **Nancy Hammes**, assistant professor of reading, retired with 15 years of service; **Linda King**, coordinator of adult education, retired with 19 years of service; **George Knight**, skilled tradesman, retired with 25 years of service; **Judith McKay**, associate professor of English, retired with 26 years of service; **Lanny Smith**, information tech manager, retired after 12 years of service; **Dianne Tiner**, vice chancellor for ASU-Heber Springs, retired after 24 years of service; **Dottie Whiteside**, director of workforce development and continuing education, retired with 15 years of service and **Gerre Wisdom**, assistant professor of reading, retired with 20 years of service.



# ASU-BEEBE ALUMNI 50-YEAR CLASS REUNION!

15



1950s CLASS REUNION!



**ASU-Beebe Alumni from the 1950s** reunited in the Student Center on April 16. **Eighty-seven alumni attended**, some from as far away as Florida. The walls of the conference room were lined with pictures and memorabilia from the 50s. Since basketball was an integral part of ASU-Beebe in the 50s, **Coach Marvin Speight** was honored with a plaque. The alumni also toured the campus after lunch to see its growth. The alumni who attended the reunion were so pleased to see old friends that they voted to come back in two years!



# SCHOLARSHIP RECIPIENTS CONGRATULATIONS!



**Joshua Lacey** received the **ASU-Beebe Alumni Book Scholarship**. He is pictured with Paul Ramsey and Natasha Richards.



**Carrie Abegglen** received the **ASU-Beebe Development Council Scholarship**. She is pictured with Jim Haynes, Chuck Wisdom, and Jeremy Gillam.



**Leah Hadder** received the **Jones Family Scholarship**. She is pictured with Keith Pinchback, vice chancellor of Institutional Advancement.



**Joel Ross** (left) received the **Pizza Pro Scholarship** from Keith Karolychik from Pizza Pro.



**Sarai Green** received the **Shurley Scholarship**. Pictured (left to right) are Ruth Kemp, Brenda Shurley, Sarai Green, and David Green.



**Kimberly Heidelberg** (left) received the **Spradlin Family Scholarship** from Tonia Spradlin.

# 2010-2011 CULTURAL EVENTS

## SPONSORED BY CENTENNIAL BANK



17

**ASU-BEEBE Presents the 2010 - 2011 Cultural Season**  
*Melody, Mystery, Magic & Mirth. Join us for a marvelously good time all year long!*

### The Centennial Bank Concert & Lecture Series

	<p><b>September 9 @ 7:30 PM</b>  <b>Zane Williams</b>                  Zane Williams is a Texas singer-songwriter who combines folk, rock, honky-tonk and bluegrass influences when crafting his award-winning songs.</p>		<p><b>October 30 @ 2:00 PM</b>  <b>Children's Theater of Arkansas</b>  <i>Alice in Wonderland</i> blends fantasy, curiosity and wonder in the most enchanting way.</p>
	<p><b>January 13 @ 7:30 PM</b>  <b>3 Miles from Providence</b>                  Formed in Searcy, Arkansas; 3MFP won the Feed the Need Battle of the Bands and the Alice 107.7 Battle of the Bands. 3 MFP has played Juanita's, Vino's and the Rev Room.</p>		<p><b>November 2 @ 8:00 PM</b>  <b>FreakShow Deluxe, Carnival Sideshow</b>                  Winner of the 2010 Hollywood Fringe Festival's Award for Best Cabaret/Circus! FreakShow Deluxe hits the stage like a raucous, sexy freight-train.</p>
	<p><b>January 27 @ 7:30 PM</b>  <b>AnnaMaria; a Musical Journey</b>                  As a classical and flamenco guitarist, her style speaks of her proud heritage. Her educational presentations are full of her passion for her culture and educating others.</p>		<p><b>February 17 @ 7:30 PM</b>  <b>Scratch Track</b>                  Blending hip-hop, rock, soul, and blues into a sonic gumbo, Scratch Track brings something extraordinary, unique, and equally refreshing to modern music.</p>
	<p><b>March 10 @ 7:30 PM</b>  <b>Afrique Aya</b>                  A group of dancers and drummers committed to sharing the joyful and spirited music and culture of West Africa. Inspired by rhythms and rituals from Ivory Coast.</p>		<p><b>April 21 @ 7:30 PM</b>  <b>The Annie Moses Band</b>                  Five extraordinary musicians from the same family tree with a sound all their own. They call it chamber pop, a spicy blend of classical, jazz, and pop mixed with some good old fashioned country.</p>

### The Theater and Music Departments' Play & Concert Season

<p><b><i>Curio</i></b>                  October 15, 16, 17 &amp; 29                  An original, black comedy about the absurdity of rampant consumption and our empty hunger for other people's drama.</p>	<p><b>ASUB Music Band Concerts</b>                  Fall: November 11                  Spring: TBA                  Free to the Public!</p>	<p><b>ASUB Music Choir Concerts</b>                  Fall: November 18                  Spring: TBA                  Free to the Public!</p>	<p><b><i>A Christmas Carol</i></b>                  December 4, 5, 7 &amp; 8                  The classic Dickens holiday story about generosity of the heart and redemption of the spirit.</p>
<p><b>The Madrigal Feaste</b>                  December: TBA                  Pageantry, comedy, delicious food and; of course, beautiful music! ASUB's Christmas season tradition is back!                  Please ask about Special Pricing for this Event.</p>	<p><b>ASUB Theater Student Showcase</b>                  February 11, 12 &amp; 13                  A yet to be announced show; directed, designed, performed and produced by ASUB students.</p>	<p><b><i>Titus Andronicus</i></b>                  The 44th Annual Arkansas Shakespeare Festival                  April 15, 16, 17 &amp; 18                  The Bard's earliest and most bloody tragedy. A gripping, cautionary tale of deception, avarice and revenge.</p>	<p><b>CALL</b>                  (501) 882-8951                  For Tickets and Information</p>



SPECIAL THANKS TO OUR FRIENDS AT CENTENNIAL BANK FOR SPONSORING OUR 2010-2011 CULTURAL EVENTS!



ARKANSAS STATE  
UNIVERSITY  
BEEBE

Beebe, Heber Springs, Searcy  
Little Rock Air Force Base

ARKANSAS STATE UNIVERSITY - BEEBE  
P.O. BOX 1000  
BEEBE, ARKANSAS 72012  
[www.ASUB.EDU](http://www.ASUB.EDU)

ADDRESS SERVICE REQUESTED



**DR. LES WYATT, ASU SYSTEM PRESIDENT, 1995 - 2010**

The faculty and staff of ASU-Beebe would like to thank Dr. Les Wyatt for his 15 years of dedication to our ASU System. We were honored to have him join us on our campuses over the years.